

PRESS-FIT THREADED BUSHES CLOSED

BBSO, BBSOS, BBSO4

Thread d_1	hole- \emptyset in metal sheet +0,08 0	d_2 \emptyset_{13}	d_3	Wrench- size sw	min thick- ness metal sheet sm	Dis- tance to middle hole	Ordering description		Dis- tance to mid- dle hole	Ordering de- scription Stainless steel, passivated
							Carbon Steel, galvanized colorless pas- sivated	Stainless steel, passivated		
M3	4,20	4,19	4,4	4,8	1,0	6,0	BBSO-M3-L	BBSOS-M3-L	6,0	BBSO4-M3-L
	5,40	5,39	5,6	6,4	1,0	6,8	BBSO-3,5M3-L	BBSOS-3,5M3-L	7,1	BBSO4-3,5-M3-L
M4	7,20	7,12	7,3	7,9	1,3	8,0	BBSO-M4-L	BBSOS-M4-L	8,4	BBSO4-M4-L
M5	7,20	7,12	7,3	7,9	1,3	8,0	BBSO-M5-L	BBSOS-M5-L	8,4	BBSO4-M5-L

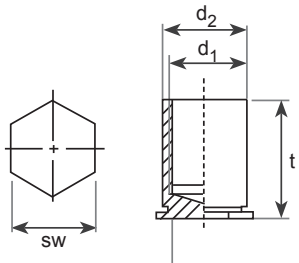

Errors and changes excepted, length tolerance ((L +0,05 / -0,13)
 BBSO4: (L+0,05 / -0,08)

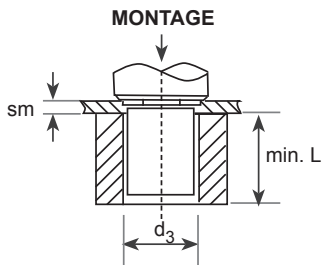

			Length									
BBSO-M3-L	BSOS-M3-L	BBSO4-M3-L	6	8	10	12	14	16	18	20	22	25
BBSO-3,5M3-L	BSOS-3,5M3-L	BBSO4-3,5-M3-L	6	8	10	12	14	16	18	20	22	25
BBSO-M4-L	BSOS-M4-L	BBSO4-M4-L	6*	8	10	12	14	16	18	20	22	25
BB SO-M5-L	BSOS-M5-L	BBSO4-M5-L	- / 6	8	10	12	14	16	18	20	22	25
thread depth t			3,2	4	5	6,5	9,5					

Type BBSO: case-hardened steel, zinc plated, colorless passivated (code ZI), for sheet metal hardening up to HRB-80.

Type BBSOS: Stainless steel 18/8 (AISI300), passivated, aluminum on request, for sheet hardness up to HRB-70.

Typ BBSO4: stainless steel 18/8 (AISI300), passivated, for sheet hardness up to HRB-88